

14M, 14MB

14M

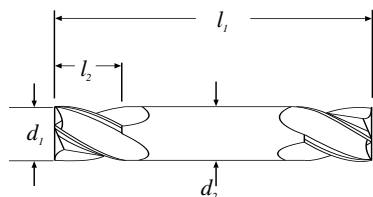

$\varnothing d_1$ mm	$\varnothing d_2$ mm	l_1 mm	l_2 mm	EDP No.	Ti-NAMITE EDP No.	Ti-NAMITE-C EDP No.	Ti-NAMITE-A EDP No.
1	3	38	2	41405	48884	48905	48926
1,5	3	38	3	41409	48885	48906	48927
2	3	38	4	41413	48886	48907	48928
2,5	3	38	5	41417	48887	48908	48929
3	3	38	6	41421	48888	48909	48930
3,5	4	50	7	41425	48889	48910	48931
4	4	50	8	41429	48890	48911	48932
4,5	4,5	63	9,5	41433	48891	48912	48933
5	5	63	10	41437	48892	48913	48934
6	6	63	12	41441	48893	48914	48935
7	8	63	12	41445	48894	48915	48936
8	8	63	12	41449	48895	48916	48937
9	9	75	14	41453	48896	48917	48938
10	10	75	14	41457	48897	48918	48939
11	12	75	14	41461	48898	48919	48940
12	12	75	16	41465	48899	48920	48941



TOLERANCES
$\varnothing d_1 = +0,000 - 0,05$
$\varnothing d_2 = +0,000 - 0,01$

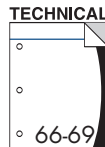
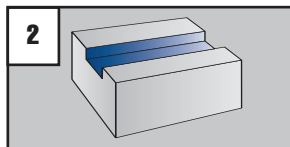
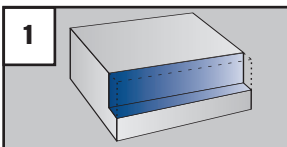

GB

14M End Mills - Double End - Square End
14MB End Mills - Double End - Ball End
Micrograin Solid Carbide
 4 Flute - Short Length - 30° Right Hand Spiral
 - Right Hand Cutting - Center Cutting

ES

Fresas 14M - Doble punta - Punta plana
Fresas 14MB - Doble punta - Punta radial
o esférica Metal duro con micrograno
 4 labios - Serie corta - Hélice a derecha 30°
 - Corte a derecha - Corte al centro

FR

Fraises 14M - Taillée aux 2 bouts - Bout plat
Fraises 14MB - Taillée aux 2 bouts - Bout
hémisphérique
Carbure monobloc, micrograin
 4 dents - Courtes - Hélice à droite, 30°
 - Coupe à droite - Coupe au centre

PT

Fresas 14M - Dois topos - Topo direito/reto
Fresas 14MB - Dois topos - Topo
boleado/esférico Metal duro microgrão
 4 navalhas/cortes - Extremidade dupla
 - Série curta - Espiral de 30° à direita
 - Corte à direita - Corte central

IT

Fresa 14M - Testa piana
Fresa 14MB - Testa semisferica
Micrograna
 Serie extra corta - Fresa doppia con testa piana e
 semisferica a 4 tagli - Elica destra a 30°
 - Taglio destrorso - Taglio al centro

DE

Schaftfräser 14M - Mit 2 Schneidköpfen
- Flachstirn
Schaftfräser 14MB - Mit 2 Schneidköpfen
- Rundstirn
Vollhartmetall, Feinstkorn
 4 Schneiden - 30° Rechtsdrall
 - Rechtsschneidend - Zentrumschnitt



TOLERANCES
$\varnothing d_1 = +0,000 - 0,05$
$\varnothing d_2 = +0,000 - 0,01$

14MB

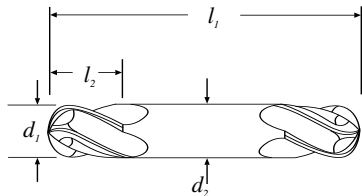

$\varnothing d_1$ mm	$\varnothing d_2$ mm	l_1 mm	l_2 mm	EDP No.	Ti-NAMITE EDP No.	Ti-NAMITE-C EDP No.	Ti-NAMITE-A EDP No.
1	3	38	2	41406	48947	48968	48989
1,5	3	38	3	41410	48948	48969	48990
2	3	38	4	41414	48949	48970	48991
2,5	3	38	5	41418	48950	48971	48992
3	3	38	6	41422	48951	48972	48993
3,5	4	50	7	41426	48952	48973	48994
4	4	50	8	41430	48953	48974	48995
4,5	4,5	63	9,5	41434	48954	48975	48996
5	5	63	10	41438	48955	48976	48997
6	6	63	12	41442	48956	48977	48998
7	8	63	12	41446	48957	48978	48999
8	8	63	12	41450	48958	48979	49000
9	9	75	14	41454	48959	48980	49001
10	10	75	14	41458	48960	48981	49002
11	12	75	14	41462	48961	48982	49003
12	12	75	16	41466	48962	48983	49004

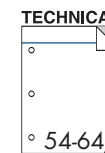
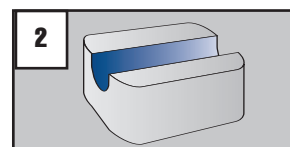
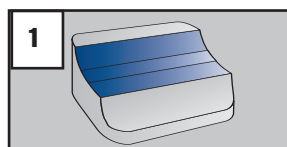

GB

15M End Mills - Double End - Square End
15MB End Mills - Double End - Ball End
Micrograin Solid Carbide
 2 Flute - Short Length - 30° Right Hand Spiral
 - Right Hand Cutting - Center Cutting

ES

Fresas 15M - Doble punta - Punta plana
Fresas 15MB - Doble punta - Punta radial o esférica
Metal duro con micrograno
 2 labios - Serie corta - Hélice a derecha 30°
 - Corte a derecha - Corte al centro

FR

Fraises 15M - Taillée aux 2 bouts - Bout plat
Fraises 15MB - Taillée aux 2 bouts - Bout hémisphérique
Carbure monobloc, micrograin
 2 dents - Courtes - Hélice à droite, 30°
 - Coupe à droite - Coupe au centre

PT

Fresas 14M - Dois topos - Topo direito/reto
Fresas 14MB - Dois topos - Topo boleado/esférico
Metal duro microgrão
 2 navalhas/cortes - Extremidade dupla
 - Série curta - Espiral de 30° à direita
 - Corte à direita - Corte central

IT

Frese 15M - Testa piana
Frese 15MB - Testa semisferica
Micrograna
 Serie extra corta - Frese doppie con testa piana e semisferica a 2 tagli - Elica destra a 30°
 - Taglio destrorso - Taglio al centro

DE

Schaftfräser 15M - Mit 2 Schneidköpfen
 - Flachstirn
Schaftfräser 15MB - Mit 2 Schneidköpfen
 - Rundstirn
Vollhartmetall, Feinstkorn
 2 Schneiden - 30° Rechtsdrill
 - Rechtsschneidend - Zentrumschnitt

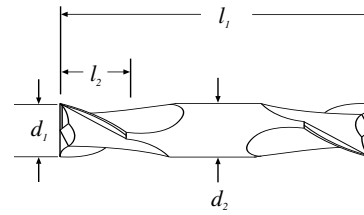

$\varnothing d_1$ mm	$\varnothing d_2$ mm	l_1 mm	l_2 mm	EDP No.	Ti-NAMITE EDP No.	Ti-NAMITE-C EDP No.	Ti-NAMITE-A EDP No.
1	3	38	2	41505	49010	49031	49052
1,5	3	38	3	41509	49011	49032	49053
2	3	38	4	41513	49012	49033	49054
2,5	3	38	5	41517	49013	49034	49055
3	3	38	6	41521	49014	49035	49056
3,5	4	50	7	41525	49015	49036	49057
4	4	50	8	41529	49016	49037	49058
4,5	4,5	63	9,5	41533	49017	49038	49059
5	5	63	10	41537	49018	49039	49060
6	6	63	12	41541	49019	49040	49061
7	8	63	12	41545	49020	49041	49062
8	8	63	12	41549	49021	49042	49063
9	9	75	14	41553	49022	49043	49064
10	10	75	14	41557	49023	49044	49065
11	12	75	14	41561	49024	49045	49066
12	12	75	16	41565	49025	49046	49067



TOLERANCES

$\varnothing d_1 = +0,000 - 0,05$
 $\varnothing d_2 = +0,000 - 0,01$

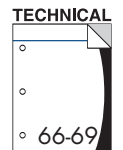
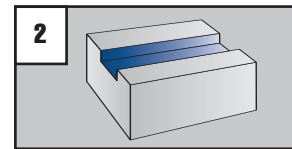
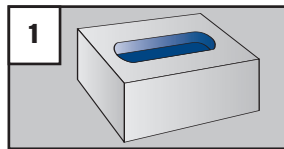

15MB

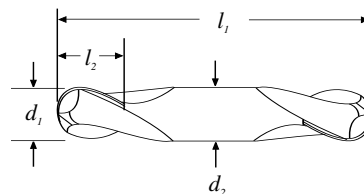

$\varnothing d_1$ mm	$\varnothing d_2$ mm	l_1 mm	l_2 mm	EDP No.	Ti-NAMITE EDP No.	Ti-NAMITE-C EDP No.	Ti-NAMITE-A EDP No.
1	3	38	2	41506	49073	49094	49115
1,5	3	38	3	41510	49074	49095	49116
2	3	38	4	41514	49075	49096	49117
2,5	3	38	5	41518	49076	49097	49118
3	3	38	6	41522	49077	49098	49119
3,5	4	50	7	41526	49078	49099	49120
4	4	50	8	41530	49079	49100	49121
4,5	4,5	63	9,5	41534	49080	49101	49122
5	5	63	10	41538	49081	49102	49123
6	6	63	12	41542	49082	49103	49124
7	8	63	12	41546	49083	49104	49125
8	8	63	12	41550	49084	49105	49126
9	9	75	14	41554	49085	49106	49127
10	10	75	14	41558	49086	49107	49128
11	12	75	14	41562	49087	49108	49129
12	12	75	16	41566	49088	49109	49130



TOLERANCES

$\varnothing d_1 = +0,000 - 0,05$
 $\varnothing d_2 = +0,000 - 0,01$

